



10 Ft. USB to Serial Converter

TU-S910 (v3.2R)

- Connect a RS-232 serial device, such as a switch, a modem, to a USB port on your computer
- 10 ft. / 3m cable for easy installation
- Supports USB 1.1, and compatible with USB 2.0 and USB 3.0 ports
- Supports Windows® and Mac® operating systems

TRENDnet's 10 Ft. USB to Serial Converter Cable, model TU-S910, allows users to conveniently connect an RS-232 serial device, such as a switch, modem or printer, to a USB port on your desktop PC or laptop. The 10 ft. USB to serial adapter supports both Windows® and Mac® operating systems. Integrated cables provide setup flexibility and accommodates most installation scenarios.



USB

The USB to serial adapter is compatible with USB 1.1, 2.0 and 3.0 devices.



RS-232 Serial Connector

Connect a RS-232 serial devices, such as switches, modems or printers, to standard USB ports on laptops and desktops.



10 Feet

10 Ft. Flexible Cable

Integrated and flexible 3m (10 ft.) USB cable accommodates most installation scenarios.

NETWORKING SOLUTION

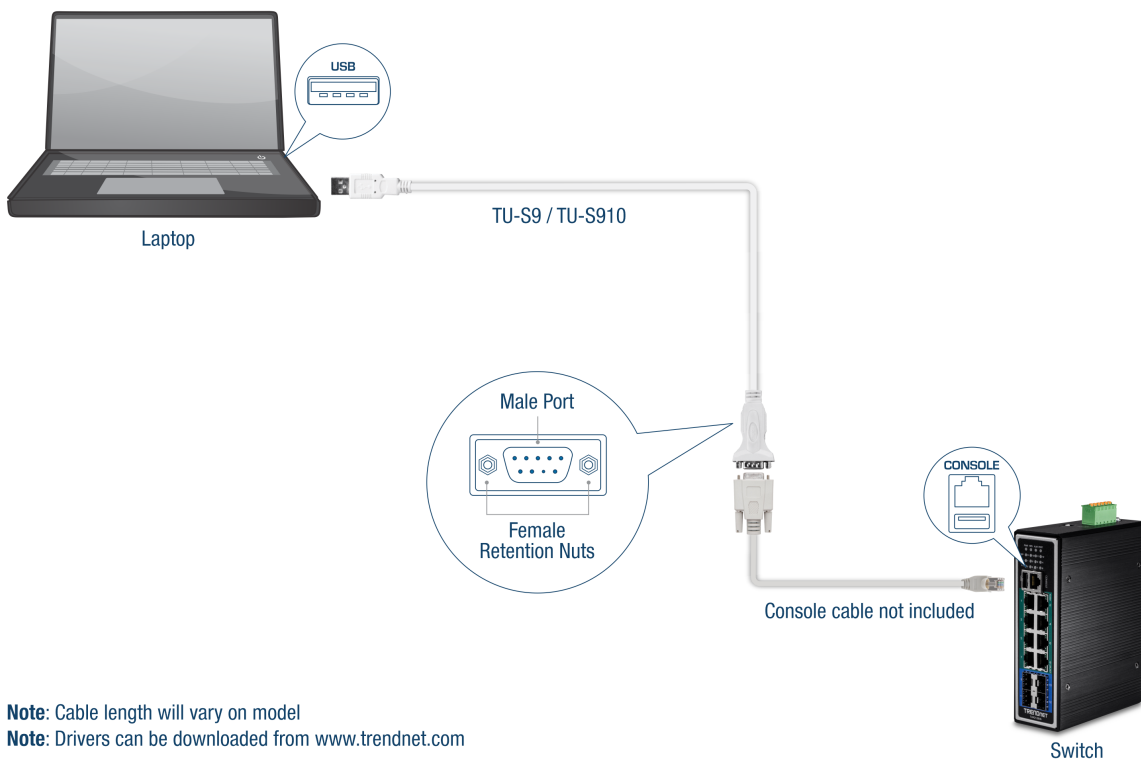

Note: Cable length will vary on model

Note: Drivers can be downloaded from www.trendnet.com

FEATURES



Easy Setup

Simple installation in seconds



Long & Flexible Cable

Integrated and flexible 3m (10 ft.) USB cable accommodates most installation scenarios



RS-232

Connect a RS-232 serial devices, such as switches, modems or printers, to standard USB ports on laptops and desktops.



USB

The USB to serial adapter is compatible with USB 1.1, 2.0 and 3.0 devices.



Operating Systems

The USB to serial adapter is compatible with Windows® and Mac® operating systems

SPECIFICATIONS

Standards

- USB 1.1

Interface

- 1 x USB Type A
- 1 x RS-232 (9-pin) male
- Cable length: 3m (10 ft.)

Data Rate

- Up to 6Mbps

Supported OS

- Windows® 11, 10, 8.1, 8, 7
- Mac OS® 10.11, 10.10, 10.9, 10.8, 10.7, 10.6

Operating Temperature

- 0° – 40° C (32° – 104° F)

Operating Humidity

- Max. 85% non-condensing

Power

- USB powered

Power Consumption

- 500mA (max.)

Dimensions

- RS-232 connector: 65 x 35 x 10mm (2.55 x 1.4 x 0.4 in.)
- Cable length: 3m (10 ft.)

Weight

- 250g (8.82 oz.)

Certifications

- CE
- FCC

Warranty

- 2 year

Package Contents

- TU-S910
- Quick Installation Guide
- CD-ROM (Drivers)

All references to speed are for comparison purposes only. Product specifications, size, and shape are subject to change without notice, and actual product appearance may differ from that depicted herein.