

## Powerline 200 AV Nano Adapter Kit

TPL-308E2K (v1.0R)



The Powerline 200 AV Nano Adapter Kit, model TPL-308E2K, uses an electrical outlet to create a secure high speed network. Connect the first adapter to your network and plug the second adapter into an outlet on your electrical system for instant high speed network access. The compact form factor saves space around crowded electrical outlets. This adapter automatically connects to other TRENDnet Powerline AV adapters with no installation required—TRENDnet recommends pressing the 'Sync' button to automatically change default encryption keys.

Use up to 4 adapters to network devices in different rooms without running new cabling. Power Save mode reduces power consumption by up to 70%. Quality of Service technology prioritizes video, audio, and online gaming. LED displays convey device status for easy troubleshooting. Advanced 128-bit AES encryption secures your network. This adapter is ideal for use in buildings that interfere with wireless networking signals.

### PRODUCT OVERVIEW

- Includes two TPL-308E adapters
- 200 Mbps networking from an electrical outlet
- Compact form factor saves space
- Power Save mode reduces power consumption by up to 70%
- Use one unit to transmit, and up to 3 additional TPL-308Es to receive a network signal



## FEATURES

- Includes two TPL-308E adapters
- 200 Mbps networking over an existing electrical system
- Compliant with IEEE1901 and HomePlug® AV standards
- 1 x 10/100 Mbps Auto-MDIX Ethernet port
- Compact form factor saves space
- Adapters automatically connect using an encrypted Powerline signal
- One-touch Sync button changes encryption keys
- Three LED indicators:
  - Power (on / off)
  - Powerline Connection: green (best), amber (better), red (good), off (no connection)
  - Ethernet Connection: solid (connection), blinking (transfer activity), off (no connection)
- Connect one 200 Mbps\*\* Powerline AV Adapter to the internet and then plug in up to 3\* additional 200 Mbps\*\* Powerline AV adapters for instant connectivity
- Share data intensive files, play games, download music and more at fast data transfer rates
- Advanced 128-bit AES encryption to ensure total network security
- Supports IPv6 pass through
- Supports up to 4\*\* IGMP based IPTV streams
- Power Save mode reduces electrical consumption by up to 70%
- Neighbor network support for up to 4 overlapping networks
- Network signal transmits up to 300 meters (984 ft.)
- Auto QoS supports traffic classification and multiple priority queuing
- Optional management utility compatible with Windows 8, Windows 7 (32/64-bit), Vista (32/64-bit), and XP (32/64-bit) operating systems
- 3-year limited warranty

\* Maximum of 4 adapters (nodes) recommended for streaming video across your network.

\*\* 200 Mbps is the maximum theoretical Powerline data rate. Actual throughput will vary depending on environment.

\*\*\* Networked Powerline devices need to be plugged into power outlets that are on the same electrical system.

\*\*\*\* GFCI outlets and AFCI circuit breakers may degrade Powerline network signals.



## SPECIFICATIONS

### HARDWARE

<b>Standards</b>	<ul style="list-style-type: none"><li>• IEEE 1901, HomePlug® AV, IEEE 802.3, IEEE 802.3x, IEEE 802.3u</li></ul>
<b>Interface</b>	<ul style="list-style-type: none"><li>• 1 x 10/100 Mbps Auto-MDIX port</li><li>• 1 x Sync / Reset button</li><li>• Power prong<ul style="list-style-type: none"><li>• A: North America Type B (NEMA 5-15)</li><li>• EU: Euro Type C (CEE 7/16)</li><li>• UK : United Kingdom Type G (BS 1363)</li></ul></li></ul>
<b>Frequency Band</b>	<ul style="list-style-type: none"><li>• 2 ~ 30 MHz</li></ul>
<b>Modulation</b>	<ul style="list-style-type: none"><li>• OFDM Symbol Modulation on link synchronization, 1024/256/64/8 - QAM, QPSK, BPSK, ROBO Carrier</li></ul>
<b>Protocol</b>	<ul style="list-style-type: none"><li>• TDMA and CSMA/CA</li></ul>
<b>Speed</b>	<ul style="list-style-type: none"><li>• Powerline: up to 200 Mbps**</li><li>• Ethernet: Up to 200 Mbps (Full Duplex mode)</li></ul>
<b>Utility OS Compatibility</b>	<ul style="list-style-type: none"><li>• Windows 8, Windows 7 (32/64-bit), Vista (32/64-bit), XP (32/64-bit)</li></ul>
<b>Nodes</b>	<ul style="list-style-type: none"><li>• Up to 4 (max)</li></ul>
<b>Overlapping Powerline Networks</b>	<ul style="list-style-type: none"><li>• Up to 4 (per electrical system)</li></ul>
<b>Coverage</b>	<ul style="list-style-type: none"><li>• Up to 300 m (984 ft.)</li></ul>
<b>Security</b>	<ul style="list-style-type: none"><li>• 128-Bit AES (Advanced Encryption Standard)</li></ul>
<b>LED</b>	<ul style="list-style-type: none"><li>• Power (PWR)</li><li>• Powerline (PL) Connection<ul style="list-style-type: none"><li>• Best (Green)</li><li>• Better (Amber)</li><li>• Good (Red)</li><li>• No connection (Off)</li></ul></li><li>• Ethernet (ETH) Connection<ul style="list-style-type: none"><li>• Solid</li><li>• Blinking</li><li>• Off</li></ul></li></ul>
<b>Buttons</b>	<ul style="list-style-type: none"><li>• Sync (3 sec.) / Reset (20 sec.)</li></ul>
<b>Dimension (L x W x H)</b>	<ul style="list-style-type: none"><li>• A: 70 x 50 x 43 mm (2.76 x 1.97 x 1.69 in.) per unit</li><li>• EU: 70 x 50 x 63 mm (2.76 x 1.97 x 2.48 in.) per unit</li><li>• UK: 70 x 50 x 58 mm (2.76 x 1.97 x 2.28 in.) per unit</li></ul>
<b>Weight</b>	<ul style="list-style-type: none"><li>• A: 62.4 g (2.2 oz) per unit</li><li>• EU: 68 g (2.4 oz) per unit</li><li>• UK: 79.4 g (2.8 oz) per unit</li></ul>
<b>Power Source</b>	<ul style="list-style-type: none"><li>• 100~240 V AC, 50~60 Hz</li></ul>
<b>Consumption</b>	<ul style="list-style-type: none"><li>• Active mode: 1.75 watts (max.)</li><li>• Standby mode: 0.56 watts (max.)</li></ul>
<b>Temperature</b>	<ul style="list-style-type: none"><li>• Operating: 0° ~ 40°C (32° ~ 104°F)</li><li>• Storage: -10° ~ 55°C (14° ~ 131°F)</li></ul>
<b>Humidity</b>	<ul style="list-style-type: none"><li>• Max 95% (non-condensing)</li></ul>
<b>Certifications</b>	<ul style="list-style-type: none"><li>• CE, FCC</li></ul>

# Powerline 200 AV Nano Adapter Kit

TPL-308E2K (v1.0R)



## NETWORKING SOLUTIONS

### Powerline 200 AV Nano Adapter TPL-308E

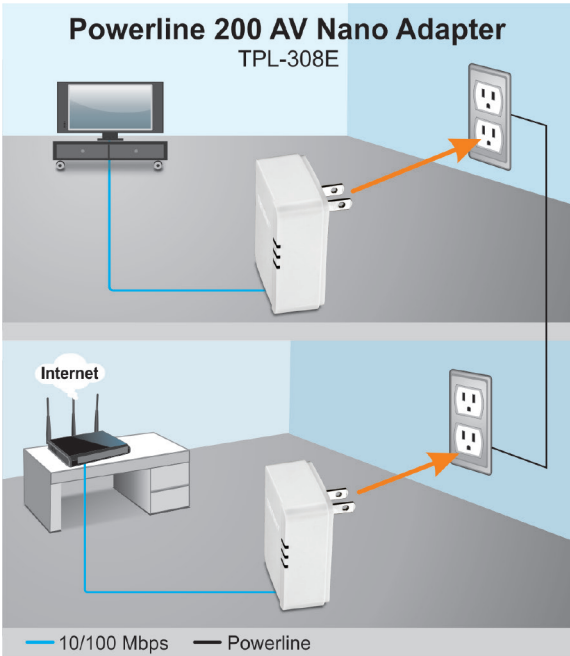

## PACKAGE CONTENTS

- 2 x TPL-308E units
- Quick Installation Guide
- CD-ROM (Utility & User's Guide)
- 2 x Network cables (1.5 m / 5 ft.)

## RELATED PRODUCTS

TPL-308E	Powerline 200 AV Nano Adapter
TPL-310AP	Powerline 200 AV Wireless Access Point
TPL-406E2K	Powerline 500 AV Nano Adapter Kit

## CONTACT INFORMATION



20675 Manhattan Place, Torrance, CA 90501 USA  
Tel: 1-310-961-5500  
Fax: 1-310-961-5511  
Web: [www.trendnet.com](http://www.trendnet.com)  
Email: [sales@trendnet.com](mailto:sales@trendnet.com)  
**1-888-326-6061**

