

TRENDNET®



Quick Installation Guide

TEW-832MDR (V1)

Table of Contents

1 Italiano

1. Prima di cominciare
2. Installazione Hardware

1. Prima di cominciare

Contenuto della confezione

- 1 x unità TEW-832MDR
- Guida rapida d'installazione
- Adattatori di alimentazione (12V DC, 1.5 A)
- Viti per montaggio a parete

Requisiti minimi

- iPhone® con iOS 10 o versione più recente
- Dispositivo mobile con Android™ 7 o più recente
- Internet a Banda Larga
- Modem installato
- TEW-832MDR2K

ENGLISH

FRANÇAIS

DEUTSCH

ESPAÑOL

PORTUGUÊS

ITALIANO

РУССКИЙ

2. Installazione hardware

Configurazione MESHnet APP Opzione 1

1. Una volta che tutte le unità sono accese, aprire l'APP per il kit pack 2 in uso che è già stato configurato in precedenza e premere il pulsante "+" posto in basso nella schermata iniziale.

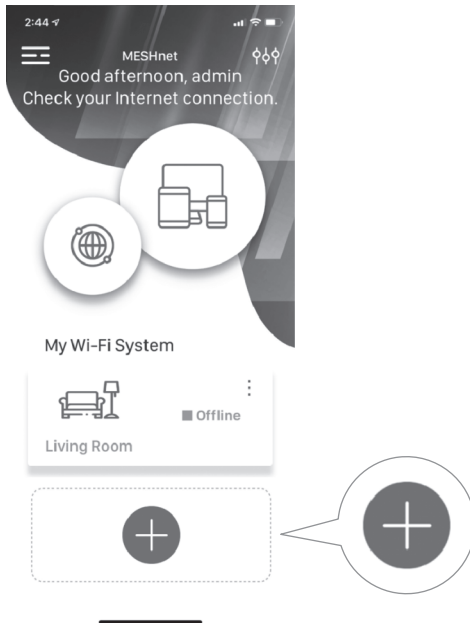

2. Cliccare **START PAIRING** (Avvia Accoppiamento).



START PAIRING

ENGLISH

FRANÇAIS

DEUTSCH

ESPAÑOL

PORTUGUÊS

ITALIANO

РУССКИЙ

3. Selezionare il nuovo **Nodo Remoto** della nuova unità singola premere e tenere premuto il pulsante **WPS/RESET** per 3 secondi e quindi rilasciarlo.

Nota: Il LED **WPS/RESET** lampeggerà sull'unità dopo aver tenuto premuto il pulsante per 3 secondi. Premerlo per **5 secondi** o più a lungo causerà il **ripristino delle impostazioni di fabbrica** dell'unità.

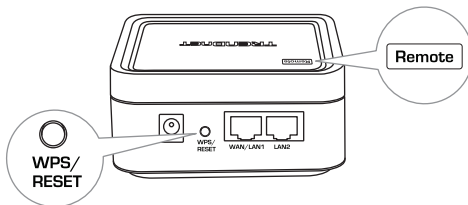

4. Confermare la connessione nell'APP, o tramite il LED **Pair** sul **Nodo Remoto** che si accende. Se il LED **Pair** lampeggia, si consiglia di trasferire il **Nodo Remoto** in una posizione più prossima ai Nodi.

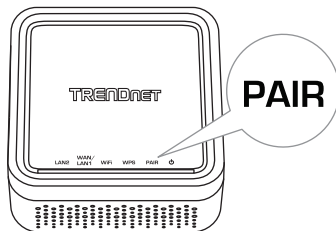
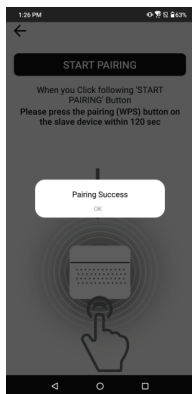

Configurazione WPS Opzione 2

1. Accedere al **Nodo Principale** della rete in uso e premere e tenere premuto il pulsante **WPS/RESET** per 3 secondi sull'unità, quindi rilasciarlo per avviare la ricerca.

Nota: Il LED **WPS/RESET** lampeggerà sull'unità dopo aver tenuto premuto il pulsante per 3 secondi. Premerlo per **5 secondi** o più a lungo causerà il **ripristino delle impostazioni di fabbrica** dell'unità.

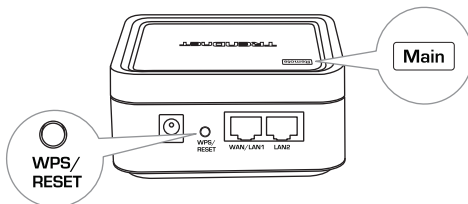

2. Selezionare il nuovo **Nodo Remoto** della nuova unità singola premere e tenere premuto il pulsante **WPS/RESET** per 3 secondi e quindi rilasciarlo.

Nota: Il LED **WPS/RESET** lampeggerà sull'unità dopo aver tenuto premuto il pulsante per 3 secondi. Premerlo per **5 secondi** o più a lungo causerà il **ripristino delle impostazioni di fabbrica** dell'unità.

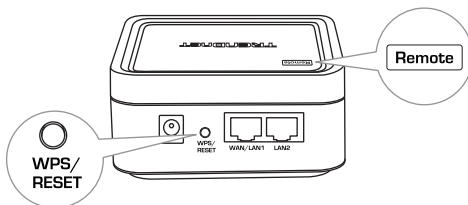

3. Confermare la connessione tramite il LED **Pair** sul **Nodo Remoto** che si accende, o nell'APP. Se il LED **Pair** lampeggia, si consiglia di trasferire il **Nodo Remoto** in una posizione più prossima ai Nodi.

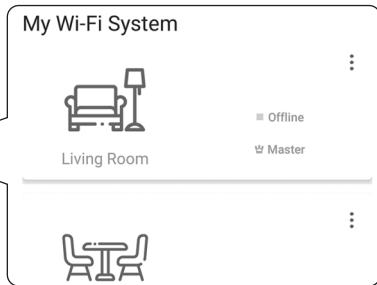
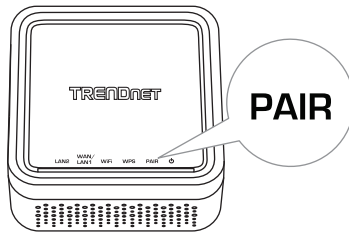
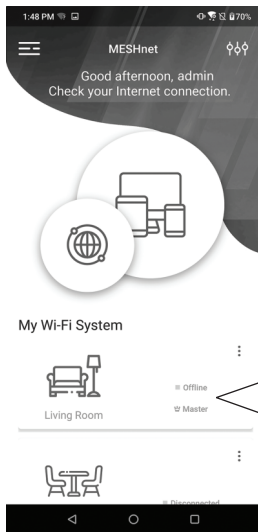

Nota: Per scaricare l'ultima versione della guida utente, visitare il sito <https://www.trendnet.com/support> e selezionare **TEW-832MDR** nell'elenco a discesa Product Download (Download Prodotti).

Federal Communication Commission Interference Statement

This device complies with Part 15 of the FCC Rules. Operation is subject to the following two conditions: (1) This device may not cause harmful interference, and (2) this device must accept any interference received, including interference that may cause undesired operation.

This equipment has been tested and found to comply with the limits for a Class B digital device, pursuant to Part 15 of the FCC Rules. These limits are designed to provide reasonable protection against harmful interference in a residential installation. This equipment generates, uses and can radiate radio frequency energy and, if not installed and used in accordance with the instructions, may cause harmful interference to radio communications. However, there is no guarantee that interference will not occur in a particular installation. If this equipment does cause harmful interference to radio or television reception, which can be determined by turning the equipment off and on, the user is encouraged to try to correct the interference by one of the following measures:

- Reorient or relocate the receiving antenna.
- Increase the separation between the equipment and receiver.
- Connect the equipment into an outlet on a circuit different from that to which the receiver is connected.
- Consult the dealer or an experienced radio/TV technician for help.

FCC Caution: Any changes or modifications not expressly approved by the party responsible for compliance could void the user's authority to operate this equipment.

This transmitter must not be co-located or operating in conjunction with any other antenna or transmitter.

Operations in the 5.15-5.25GHz band are restricted to indoor usage only.

Radiation Exposure Statement:

This equipment complies with FCC radiation exposure limits set forth for an uncontrolled environment. This equipment should be installed and operated with minimum distance 20cm between the radiator & your body.

Industry Canada statement:

This device complies with ISED's licence-exempt RSSs. Operation is subject to the following two conditions: (1) This device may not cause harmful interference, and (2) this device must accept any interference received, including interference that may cause undesired operation.

Le présent appareil est conforme aux CNR d'ISED applicables aux appareils radio exempts de licence. L'exploitation est autorisée aux deux conditions suivantes : (1) le dispositif ne doit pas produire de brouillage préjudiciable, et (2) ce dispositif doit accepter tout brouillage reçu, y compris un brouillage susceptible de provoquer un fonctionnement indésirable.

Caution :

(i) the device for operation in the band 5150-5250 MHz is only for indoor use to reduce the potential for harmful interference to co-channel mobile satellite systems;

(iii) where applicable, antenna type(s), antenna models(s), and worst-case tilt angle(s) necessary to remain compliant with the e.i.r.p. elevation mask requirement set forth in section 6.2.2.3 shall be clearly indicated.

Avertissement:

(i) les dispositifs fonctionnant dans la bande 5150-5250 MHz sont réservés uniquement pour une utilisation à l'intérieur afin de réduire les risques de brouillage préjudiciable aux systèmes de satellites mobiles utilisant les mêmes canaux;

(iii) lorsqu'il y a lieu, les types d'antennes (s'il y en a plusieurs), les numéros de modèle de l'antenne et les pires angles d'inclinaison nécessaires pour rester conforme à l'exigence de la p.i.r.e. applicable au masque d'élévation, énoncée à la section 6.2.2.3, doivent être clairement indiqués. Radiation Exposure Statement:

This equipment complies with ISED radiation exposure limits set forth for an uncontrolled environment. This equipment should be installed and operated with greater than 20cm between the radiator & your body.

Déclaration d'exposition aux radiations:

Cet équipement est conforme aux limites d'exposition aux rayonnements ISED établies pour un environnement non contrôlé. Cet équipement doit être installé et utilisé à plus de 20 cm entre le radiateur et votre corps.



Wall-mounted instructions

The Unit has two wall-mount slots on its bottom panel.

Before you begin, make sure you have two screws that indicate a diameter measurement of 0.1377 inches (4.0mm).

- (1) Determine where you want to mount the unit.
- (2) Drill two holes into the wall. Make sure adjacent holes are 4.51 inches (114 mm) apart.
- (3) Maneuver the unit so the wall-mount slots line up with the two screws.
- (4) Place the wall-mount slots over the screws and slide the unit down until the screws fit snugly into the wall-mount slots.
- (5) Screw type T3 x 15mm x 2

The equipment power supply cord shall be connected to a socket-outlet with earthing connection.

Certifications

This device complies with Part 15 of the FCC Rules.

Operation is subject to the following two conditions:

- (1) This device may not cause harmful interference.
- (2) This device must accept any interference received.

Including interference that may cause undesired operation.



	AT	BE	BG	HR	CY	CZ	DK
	EE	FI	FR	DE	EL	HU	IE
	IT	LV	LT	LU	MT	NL	PL
	PT	RO	SK	SI	ES	SE	UK

This device is restricted to indoor use

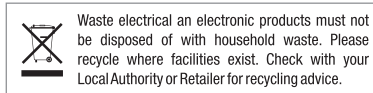

Technical Support

If you have any questions regarding the product installation, please contact our Technical Support.

Toll free US/Canada: **1-866-845-3673**

Regional phone numbers available

at www.trendnet.com/support

TRENDnet

20675 Manhattan Place

Torrance, CA 90501

USA

Applies to PoE Products Only: This product is to be connected only to PoE networks without routing to the outside plant.

Note

The Manufacturer is not responsible for any radio or TV interference caused by unauthorized modifications to this equipment. Such modifications could void the user's authority to operate the equipment.

Advertencia

En todos nuestros equipos se mencionan claramente las características del adaptador de alimentación necesario para su funcionamiento. El uso de un adaptador distinto al mencionado puede producir daños físicos y/o daños al equipo conectado. El adaptador de alimentación debe operar con voltaje y frecuencia de la energía eléctrica domiciliar existente en el país o zona de instalación.

Product Warranty Registration

Please take a moment to register your product online. Go to TRENDnet's website at:

www.trendnet.com/register