



54Mbps 802.11g Wireless PC Card TEW-421PC (b1)

TRENDnet's TEW-421PC 54Mbps Wireless CardBus PC Card allows laptop users the mobile freedom to connect at home, in the office or to wireless hotspots on the road. It complies with the IEEE 802.11g standard, making it backward compatible with 802.11b networks for assured compatibility as you roam between networks. Advanced 128-bit WEP encryption is supported to provide secure access for your data. Cut the wires and move freely with TRENDnet's 802.11g wireless products.

FEATURES

- Wi-Fi Compliant with IEEE 802.11g and IEEE 802.11b Standards
- Uses 2.4 GHz Frequency Band, which Complies with Worldwide Requirements
- Supports Ad-Hoc (Peer-to-Peer) Mode or Infrastructure (AP-Client) Mode
- Dynamic Data Rate Scaling at 54, 48, 36, 24, 18, 12, 9 and 6Mbps for 802.11g
- Dynamic Data Rate Scaling at 11, 5.5, 2 and 1Mbps for 802.11b
- Maximum Reliability, Throughput and Connectivity with Automatic Data Rate Switching
- Compatible with Windows 98(SE)/ME/2000/XP (SP1/SP2)
- Supports 64/128-bit WEP and WPA-PSK
- Integrated Microstrip Dual Diversity Antenna for the Multi-Path Environment
- Low Interference and High Susceptibility Guarantee Reliable Performance
- Range of 35~100 meters indoor, 100~300 meters outdoor (depends on the environment)
- Simple User Setup & Diagnostics Utilities
- 3-Year Warranty

BENEFITS

Economical:

Save time, labor, and materials; compare with wired network installation.

Flexible:

Creates wireless peer-to-peer network in Ad-Hoc mode or connects to Ethernet LAN in Infrastructure mode using Wireless Access Point or Wireless Router.

Cost Effective:

Supports IEEE 802.11b and IEEE 802.11g standards; connects to any IEEE 802.11b and 802.11g wireless network.

Performance:

54Mbps high-speed wireless connection.

54Mbps 802.11g Wireless PC Card

TEW-421PC (b1)

SPECIFICATIONS

Hardware	
Interface	• 32-Bit CardBus Type II Card
Standards	• IEEE 802.11b and IEEE 802.11g
Antenna	• Integrated Microstrip Dual Diversity Antenna
LED Indicator	• Power, Link
Power Consumption	• Receive Mode: 240mA • Transmit Mode: 530 mA
Supported OS	• Windows 98(SE), ME, 2000, XP(SP1/SP2)
Dimensions (LxWxH)	• 118 x 54 x 7 mm (4.65 x 2.1 x 0.2 inches)
Weight	• 36g (1.27oz)
Temperature	• Operating: 0° ~ 40° C (32° ~ 104° F) • Storage: -10° ~ 70° C (14° ~ 158° F)
Humidity	• 10% ~ 95%max (Non-condensing)
Certification	• FCC, CE, ETS
Wireless	
Module Technique	• 802.11b: CCK (11 and 5.5Mbps), DQPSK (2Mbps), DBPSK (1Mbps) • 802.11g: OFDM
Frequency	• 2.412 to 2.484 GHz (Industrial Scientific Medical Band)
Media Access Protocol	• CSMA/CA with ACK
Data Rate (auto fallback)	• 802.11b: 11Mbps, 5.5Mbps, 2Mbps, and 1Mbps • 802.11g: 54Mbps, 48Mbps, 36Mbps, 24Mbps, 18Mbps, 12Mbps, 9Mbps and 6Mbps
Transmit Power	• 15dBm (typically) @ 802.11b • 12dBm (typically) @ 802.11g
Receiving Sensitivity	• 54Mbps 10% PER @ -73 dBm (typical) • 11Mbps 8% PER @ -85 dBm (typical)
Security	• WPA-PSK, 64/128-Bit WEP (Hex or ASCII), WEP-Passphrase
Channels	• 1~14 Channels (Universal Domain Support)

NETWORKING SOLUTIONS

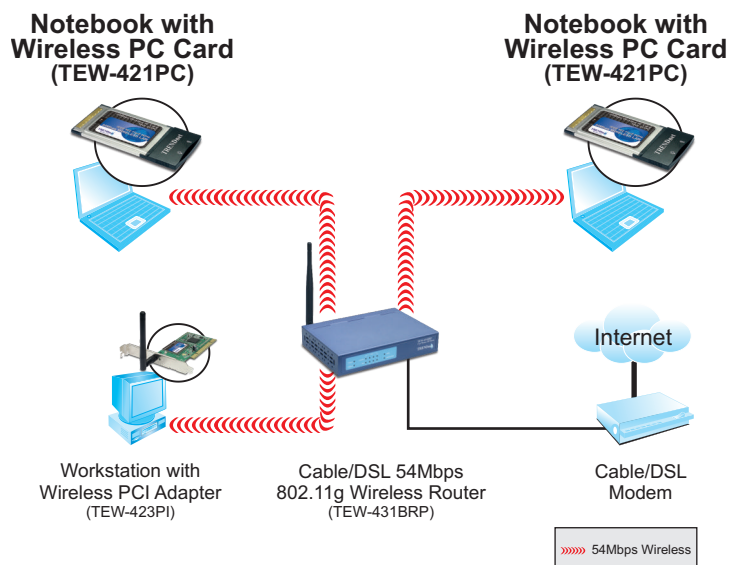

PACKAGE CONTENTS

- TEW-421PC
- Utility & Driver CD-ROM
- Multi-Language Quick Installation Guide

RELATED PRODUCTS

TEW-423PI	802.11g 54Mbps Wireless PCI Adapter
TEW-424UB	54Mbps 802.11g Wireless USB 2.0 Adapter
TEW-431BRP	Cable/DSL 802.11g 54Mbps Wireless Router

ORDERING INFORMATION

TRENDnet

3135 Kashiwa Street, Torrance, CA 90505 USA
 Tel: 1-888-777-1550
 Fax: 310-891-1111
 Web: www.trendnet.com
 Email: sales@trendnet.com

To Order Please Call:

1-888-326-6061

