



Dual-Band 802.11a/g 8/6dBi Indoor Directional Antenna with Mounting Base TEW-AI86DB

TEW-AI86DB Indoor Directional Antenna provides more power and greater range for your wireless network. As an optional antenna for your IEEE 802.11b/g 2.4GHz or 802.11a 5GHz wireless network equipment, TEW-AI86DB will significantly improve signal strength and quality. TEW-AI86DB will work with any brand of device with Reverse SMA Male Connector!

*** This dBi gain does not factor cable loss. Performance estimations are for typical use; range will vary with site conditions.**

FEATURES

- Compatible with 2.4GHz 802.11b/g or 5GHz 802.11a wireless devices.
- Detachable antenna base allows high gain antenna to be optionally connected to Wi-Fi device, avoiding cable loss/attenuation
- Magnetic base allows convenient and optimal relocation to wall or any metallic surface
- Works with any brand of wireless devices with reverse SMA male connector
- Serves as an indoor directional relocation antenna
- Enhances wireless coverage and improve signal transmission and reception
- Adjustable antenna face can tilt up to 180° and rotate up to 360° for optimal performance.
- No configuration or installation software required
- 3-Year Warranty

ANTENNA SOLUTION

Adjustable Antenna Face Tilt 180° and Rotate 360°

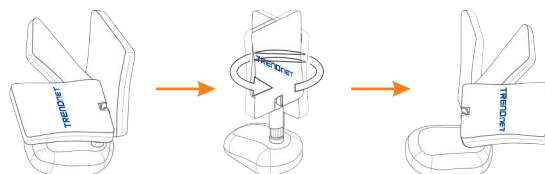

Antenna Solution



Dual-Band 802.11a/g 8/6dBi Indoor Directional Antenna with Mounting Base TEW-AI86DB

SPECIFICATIONS

Hardware	
Frequency range	• 802.11a: 4.9 ~ 5.8GHz • 802.11b/g: 2.4 ~ 2.5GHz
Gain	• 802.11b/g: 8dBi • 802.11b/g: 6dBi
VSWR	• 2.0:1
Polarization	• Linear, Vertical
HPBW/ Horizontal	• 802.11a: 50° • 802.11b/g: 75°
HPBW/ Vertical	• 802.11a: 60° • 802.11b/g: 70°
Power Handling	• 2W (cw)
Impedance	• 50 Ohms
Connector	• Reverse SMA Female
Dimension	• Antenna: 128 x 85 x 15 mm (5.04 x 3.35 x 0.59in.) • Base: 80 x 58 x 28 mm (3.15 x 2.28 x 1.1 in)
Weight	• Antenna: 51g (4.5oz.) • Base: 82g (2.9oz.)
Temperature	• -10°C ~ 55°C (14°F ~ 131°F)
Humidity	• 95% at 25°C

RADIATION PATTERNS

E-plane Co-polarization Pattern

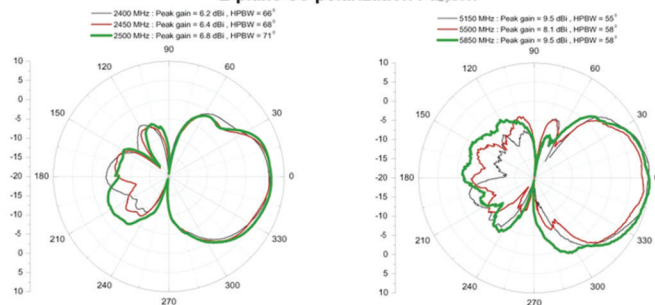

H-plane Co-polarization Pattern

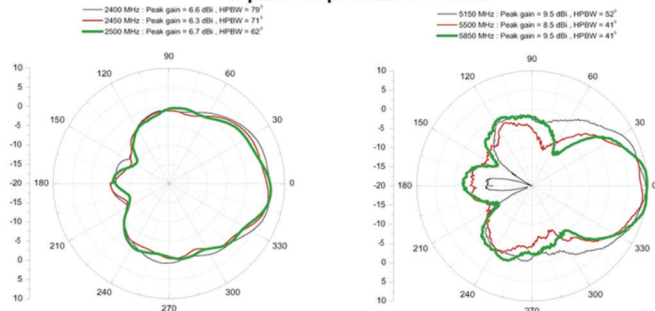

PACKAGE CONTENTS

- TEW-AI86DB
- Multi-Language User's Guide
- Mounting Kit

RELATED PRODUCTS

TEW-AI86D	Dual-Band 802.11a/g 8/6dBi Indoor Directional Antenna
TEW-AI750	Dual-Band 802.11a/g 7/5dBi Indoor Omni Antenna
TEW-AI750B	Dual-Band 802.11a/g 7/5dBi Indoor Omni Antenna with Mounting Base

ORDERING INFORMATION

TRENDnet

3135 Kashiwa Street, Torrance, CA 90505 USA
Tel: 1-310-891-1100
Fax: 310-891-1111
Web: www.trendnet.com
Email: sales@trendnet.com

To Order Please Call:

1-888-326-6061

