

Lühike paigaldusjuhend

N300 WiFi Ruuter
TEW-731BR

Eesti keel

Riistvara installeerimine

Soovitav on antennid sättida vertikaalsesse positsiooni nagu pildil näidatud, et tagada wifi-võrgule optimaalne levi.

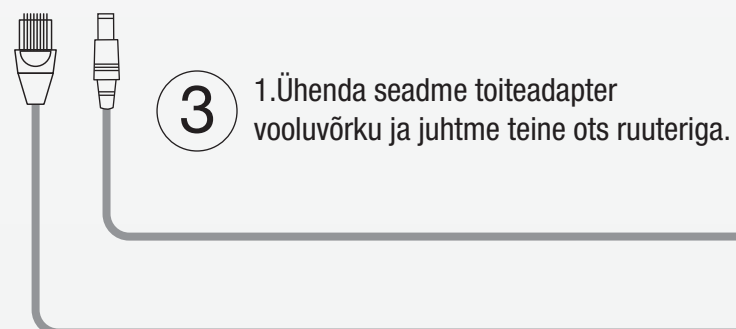
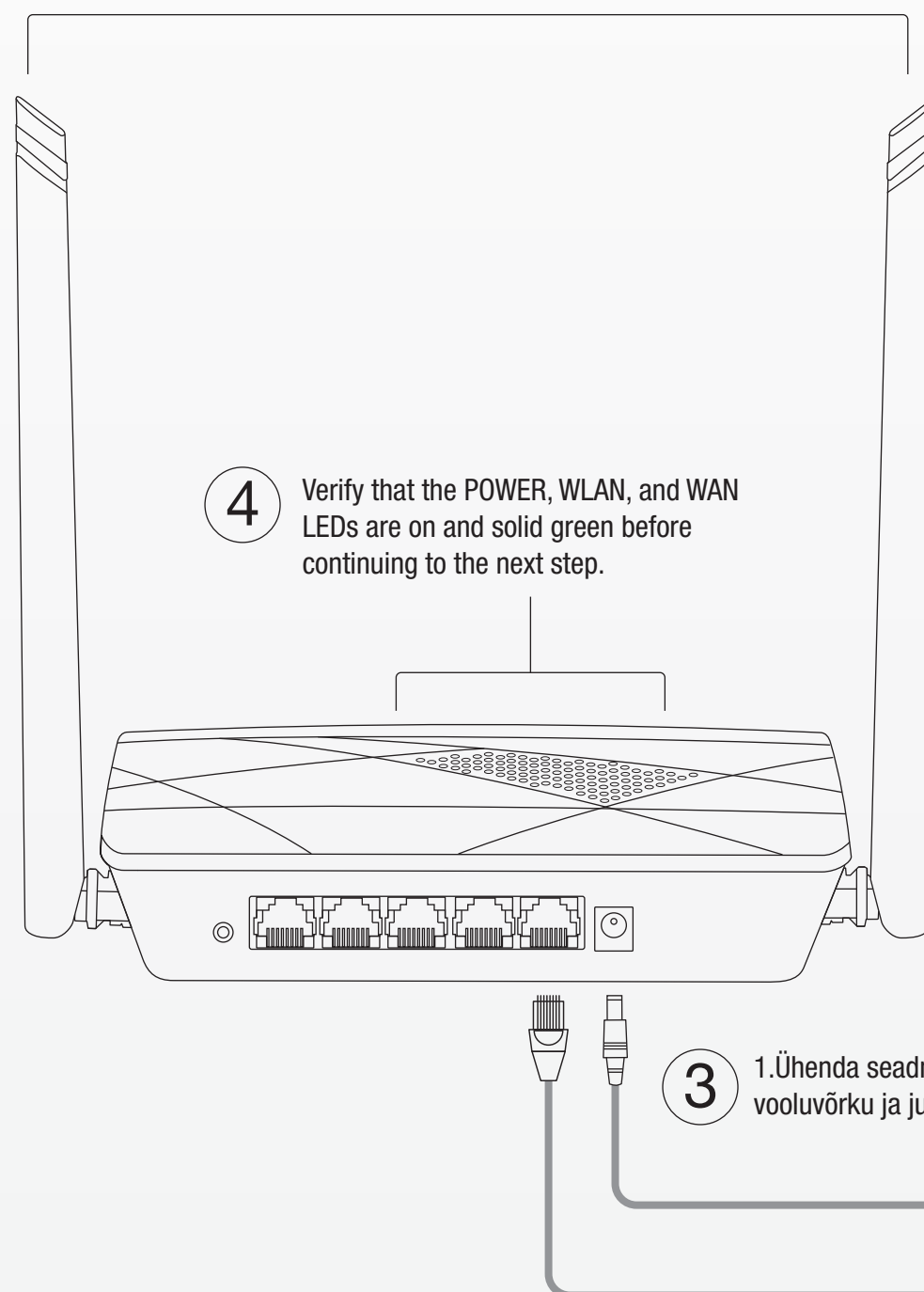

Power Adapter

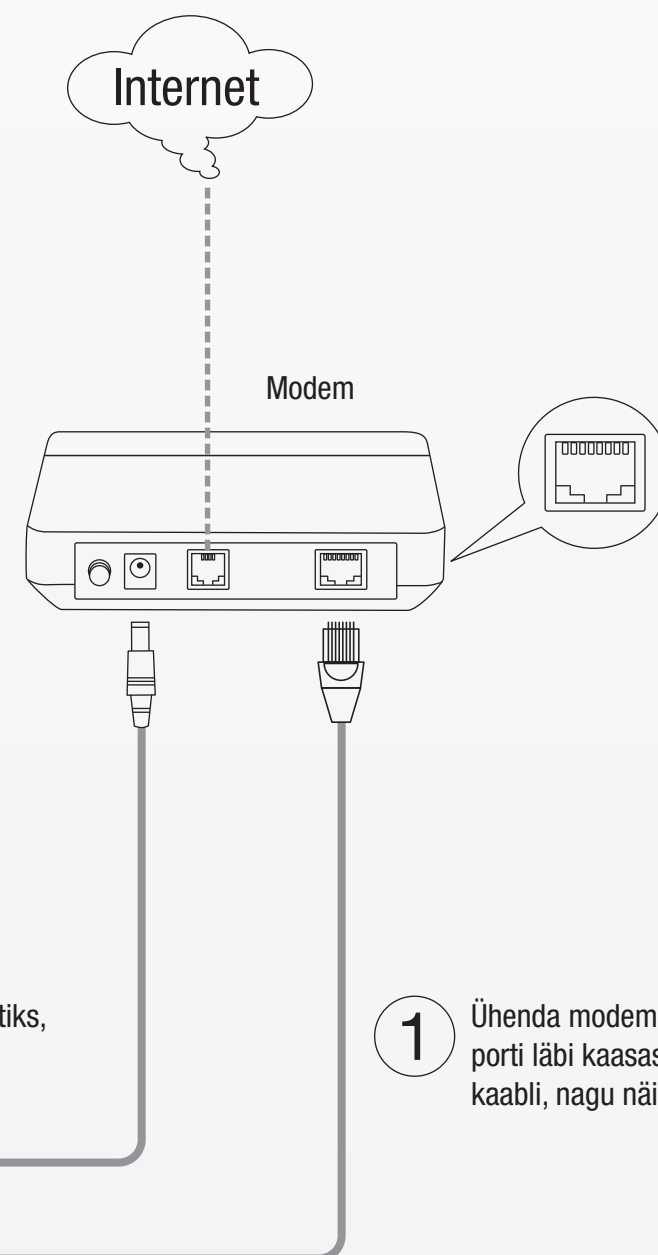
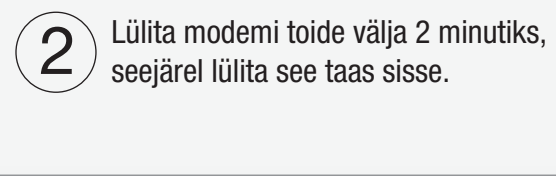
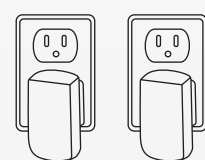

Internet

Modem

Seadistamine veebilehitseja abil

1. Ühenda ruuter oma arvutiga (kas kaabli või wifi abil).

Kaabliga

Ühenda oma arvuti ruuteriga läbi ühe LAN portidest (LAN1-4) kasutades kaasasolevat Ethernet-kaablit, nagu näidatud.

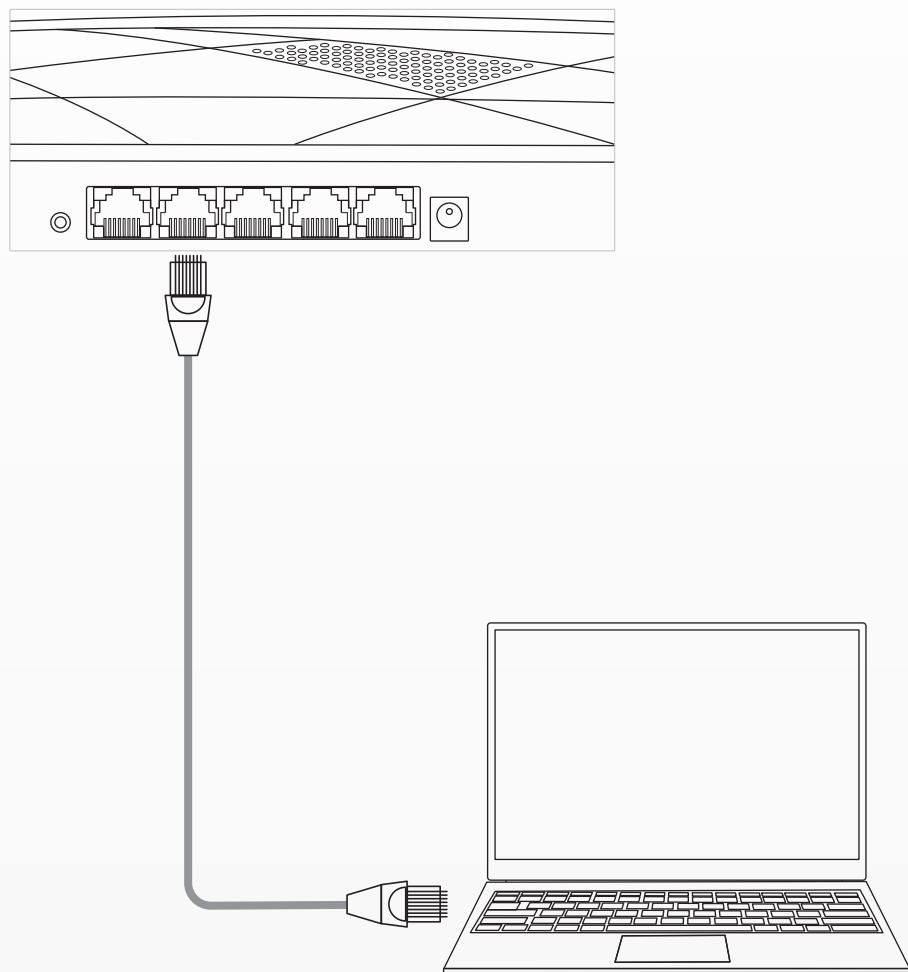

Wifi

Ühenda oma arvuti juhtmevabalt, valides pakutavate wifi-võrkude hulgast etteantud SSID nimi ja wifi parool, mille leiad kaasasolevalt sedeliit "Preset Wireless Settings" või ruuteri korpuse põhja all asetsevalt siidilt.

Preset Wireless Settings

Wi-Fi Name/SSID
TRENDnet731_XXXX

Wi-Fi Password
XXXXXXXXXXXX

Management Login
<http://tew-731br>
username: admin
password: XXXXXXXX

2. Ava veebilehitseja ning sisesta selle aadressiribale <http://tew-731br> või <http://192.168.10.1>.



3. Seadistuse viisardis vali **kasutuskeel** ja **internetiühenduse tüüp** ning vajuta **"Next"**. Kui sa pole ühenduse tüübis kindel, säilita vaikeseade **"Dynamic IP"** ning vajuta **"Next"**, et järgnevate juhiste abil viia internetiühenduse seadistamine lõpule.

WAN Connection Type

The Setup supports three popular types of connection. To make sure the connection type your ISP provides, please refer to the ISP.

- Dynamic IP - Usually for Cable Modem and the router will automatically obtain an IP address from the DHCP server.
- Static IP - This type of connection uses a permanent, fixed (static) IP address that your ISP assigned.
- PPPoE - Usually for ADSL Modem and you will need a PPPoE username and password from your ISP.

EnglishCancelNext

4. Muuda või jäta muutmata wifi vaikeseaded ning vajuta **"Next"**. Vaikimisi on unikaalne wifi-võrgu nimi ja parool sinu seadmele juba kinnitatud. Kui sa neid muudad, siis pane uued andmed kirja, et hiljem saaks ka teisi seadmeid selle wifi-võrguga ühendada.

Wireless

By default, a unique predefined WiFi Key/Password has already been assigned in order for clients to connect to your router WiFi network which can be located on the label located on the bottom of the device or on the wireless sticker included with your device for your convenience. If you would like to change the default WiFi Key/Password, please enter the WiFi Key/Password in the field below named "Key:", then click "Next". You can configure the wireless parameters and security settings of router on this step.

Disable the wireless radio.

SSID:

Channel:

Mode:

Channel Width:

Wireless Security:

- Disable Security
- WPA-PSK/WPA2-PSK AES

Key: (8-63 characters or 64 hex digits)

CancelBackNext

5. Vajuta **"Finish"** seadistuse lõpetamiseks ja oota, kuni seaded rakenduvad. Seejärel kontrolli internetiühendust erinevate saitide avamiseks veebilehitsejas.

Setup Complete

Click the 'Finish' button to finish the Setup.

Tips: Please click "Setup" on the Menu, and then click "Internet Setup" for detail settings if the router still can not access the internet.

CancelBackFinish

Declaration of Conformity

TRENDNET

Manufacturer's Name and Address

TRENDnet, Inc.
20675 Manhattan Place
Torrance, CA 90501 USA



Product Information

Model Number: TEW-731BR
Product Name: N300 WiFi Router
Trade Name: TRENDnet

TRENDnet hereby declare that the product is in compliance with the essential requirements and other relevant provisions under our sole responsibility.

Safety EN 60950-1:2006 + A11:2009 + A1:2010 + A12:2011 + A2:2013

EMC

EN 301 489-1 V1.9.2:09-2011
EN 301 489-17 V2.2.1:09-2012
EN 55022:2010 + AC:2011
EN 55024:2010 + A1:2015
EN 55032:2015

Radio Spectrum & Health

EN 300 328 V1.9.1:02-2015
EN 62311:2008

Energy Efficiency

Regulation (EC) No. 1275/2008, No. 801/2013

This product is herewith confirmed to comply with the Directives.

Directives:

Low Voltage Directive 2014/35/EC
EMC Directive 2014/30/EC
R&TTE Directive 1999/5/EC
Ecodesign Directive 2009/125/EC
RoHS Directive 2011/65/EU
REACH Regulation (EC) No. 1907/2006

Person responsible for this declaration.

Place of Issue: Torrance, California, USA

Date: July 14, 2016

Name: Sonny Su

Title: Director of Technology

Signature:

Safety notes



Before using your TRENDnet device for the first time, it is essential to read and understand all safety and operating instructions. Keep instructions in a safe place for future reference. Some TRENDnet products are rated for outdoor applications and can sustain certain weather conditions. Please refer to the product's Ingress Protection (IP) rating and the operating humidity and temperature range.

DANGER due to electricity

Warning: Never open TRENDnet devices. Doing so poses the risk of electric shock! The device is voltage free only when unplugging from the mains power supply. No physical maintenance of TRENDnet devices is required. If damage occurs, disconnect the TRENDnet device from the power outlet and contact a qualified technician ONLY.

Damage is defined as:

- If the power cable/plug is damaged
- If the device has been submerged in liquid (e.g. rain or water; except products that are rated for outdoor applications)
- If the device is inoperable
- If there is damage to the housing of the device

Only operate TRENDnet devices using a mains power supply. To disconnect devices from the mains supply, remove the device itself or its mains plug from the power outlet. The power outlet and all connected network devices should be easily accessible so that you can pull the mains plug quickly if needed. TRENDnet devices are designed for indoor use only and in a dry location (except those that are rated for outdoor applications). To clean a TRENDnet device, disconnect it from the mains supply first and only use a dry towel.

DANGER due to overheating

Never expose TRENDnet devices to extreme heat (e.g. direct sunlight, fire, or other heat sources). For outdoor rated products, please install the product in an environment that is within the product's operating temperature and humidity range. Do not interlock multiple TRENDnet devices. Only install TRENDnet devices in locations with adequate ventilation (slots and openings on the housing are used for ventilation).

- Do not cover TRENDnet devices when operating.
- Do not place any objects on TRENDnet devices.
- Do not insert any foreign objects into the openings of TRENDnet devices.
- Do not place TRENDnet devices next to an open flame (e.g. fire or candles).
- Do not expose TRENDnet devices to direct heat (e.g. radiator or direct sunlight).

Limited Warranty

TRENDnet warrants its products against defects in material and workmanship, under normal use and service. Specific warranty periods are listed on each of the respective product pages on the TRENDnet website.

GPL/LGP General Information

This TRENDnet product includes free software written by third party developers. These codes are subject to the GNU General Public License ("GPL") or GNU Lesser General Public License ("LGPL"). These codes are distributed WITHOUT WARRANTY and are subject to the copyrights of the developers. TRENDnet does not provide technical support for these codes.

Please also go to (<http://www.gnu.org/licenses/gpl.txt>) or (<http://www.gnu.org/licenses/lgpl.txt>) for specific terms of each license.

The source codes are available for download from TRENDnet's web site (http://trendnet.com/downloads/list_gpl.asp) for at least three years from the product shipping date.

You could also request the source codes by contacting TRENDnet.

20675 Manhattan Place, Torrance, CA 90501, USA. Tel: +1-310-961-5500 Fax: +1-310-961-5511

Certifications

This device complies with Part 15 of the FCC Rules. Operation is subject to the following two conditions:

- (1) This device may not cause harmful interference.
- (2) This device must accept any interference received, including interference that may cause undesired operation.



Waste electrical and electronic products must not be disposed of with household waste. Please recycle where facilities exist. Check with your Local Authority or Retailer for recycling advice.

Technical Support

If you have any questions regarding the product installation, please contact our Technical Support.

Toll free US/Canada: 1-866-845-3673

Regional phone numbers available at www.trendnet.com/support

TRENDnet

20675 Manhattan Place
Torrance, CA 90501
USA

Copyright © 2016. All Rights Reserved. TRENDnet.

Applies to PoE Products Only: This product is to be connected only to PoE networks without routing to the outside plant.

Note

The Manufacturer is not responsible for any radio or TV interference caused by unauthorized modifications to this equipment. Such modifications could void the user's authority to operate the equipment.

Advertencia

En todos nuestros equipos se mencionan claramente las características del adaptador de alimentación necesario para su funcionamiento. El uso de un adaptador distinto al mencionado puede producir daños físicos y/o daños al equipo conectado. El adaptador de alimentación debe operar con voltaje y frecuencia de la energía eléctrica domiciliar existente en el país o zona de instalación.

Product Warranty Registration

Please take a moment to register your product online. Go to TRENDnet's website at:

www.trendnet.com/register