



Ghid de instalare in limba romana

**ANTENĂ DE INTERIOR/EXTERIOR,
CABLU DE ANTENĂ ȘI DISPOZITIV DE
PROTECȚIE LA SUPRATENSIUNI**

Table of Contents

Româna	1
1. Instalarea Antenei De Exterior	1
2. Mod De Instalare Al Dispozitivului De Protecție La Supratensiuni	4
3. Bandă Izolantă Pentru Instalare În Exterior	5
4. Instalarea Antenei De Interior	6

1. Instalarea Antenei De Exterior

Înainte de a începe instalarea antenei de interior, asigurați-vă că aveți toate produsele necesare, iar conținutul fiecărui produs este complet.



Una dintre urmatoarele tipuri de antene:

TEW-AO080	TEW-AO100	TEW-AO09D	TEW-AO14D	TEW-AO19D
				

1. Deconectati antena dipol de la router-ul sau access point-ul dvs.



2. Atasati mufa din capatul de culoare albastru al cablului de legatura (Reverse SMA) la dispozitivul Wi-Fi de care dispuneti.



3. Conectati mufa din capatul de culoare neagra al cablului de legatura (tip N) la dispozitivul de protectie la supratensiuni. Va rugam sa consultati Sectiunea 2: "Modul de instalare al dispozitivului de protectie la supratensiuni".



4. Conectati celalalt capat al dispozitivului de protectie la supratensiuni la mufa din capatul de culoare albastra al cablului de antena (tip N).

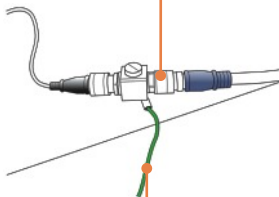

5. Conectati firul de culoare verde la un obiect cu împământare (ex.: tija metalica împământata, sistem electric cu împământare, scheletul cladirii).

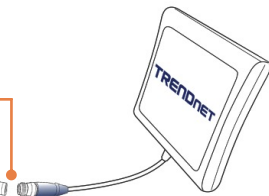

6. Conectati mufa din capatul de culoare neagra al cablului de antena (tip N) la antena.

7. Instalarea antenei de interior a luat acum sfârșit.

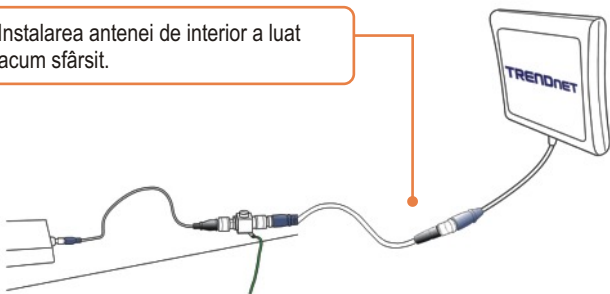

2. Mod De Instalare Al Dispozitivului De Protecție La Supratensiuni

1. Înainte de a instala antena, asigurați-vă locația router-ului/access point-ului poate fi acoperită de lungimea cablului de exterior (TEW/L406/TEW-L412). Atașați mufa din capătul de culoare albastră (Reverse SMA) al cablului de legătură la dispozitivul Wi-Fi și pe cea din capătul de culoare neagră (tip N) al cablului de antena la dispozitivul de protecție la supratensiuni.

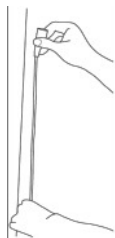

2. Poziționați pe perete suportul metalic de tip L și marcați cu un creion locul unde doriți să montați dispozitivul de protecție la supratensiuni.



3. Fixați pe perete suportul metalic cu ajutorul șuruburilor.

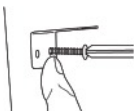

4. Montați dispozitivul de protecție la supratensiuni în suport.

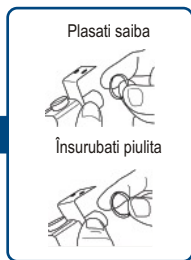
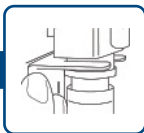
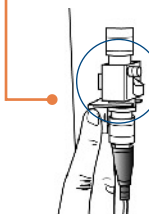

3. Bandă Izolantă Pentru Instalare În Exterior

Dacă dispozitivul dvs. este amplasat în exterior, este foarte importantă izolarea ambelor mufe cu banda izolantă, pentru protejarea lor de intemperii.



4. Instalarea Antenei De Interior

Înainte de a începe instalarea antenei de interior, va rugăm să vă asigurați că aveți toate produsele necesare, iar conținutul fiecărui produs este complet.

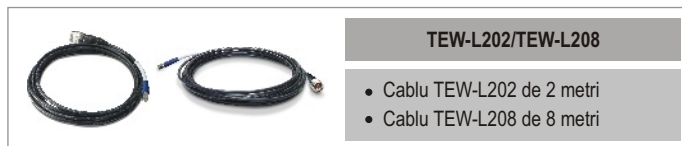

Una dintre următoarele tipuri de antene:



NOTA: Următoarele tipuri de antene de camera sunt livrate cu cabluri și se conectează direct la dispozitivul Wi-Fi de care dispuneți, fără să fie nevoie de adaptori sau alte astfel de dispozitive:



1. Deconectati antena dipol de la router-ul sau access point-ul dvs.

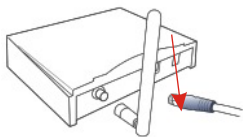

2. Atasati mufa de la capatul de culoare albastra (Reverse SMA) al cablului de interior (TEW-L202/TEW-L208) direct la dispozitivul Wi-Fi de care dispuneti.

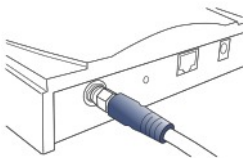

3. Conectati mufa de la capatul de culoare neagra (tip N) al cablului de interior la mufa de la capatul de culoare albastra (tip N) al antenei.



4. Instalarea antenei de interior a luat acum sfârșit.

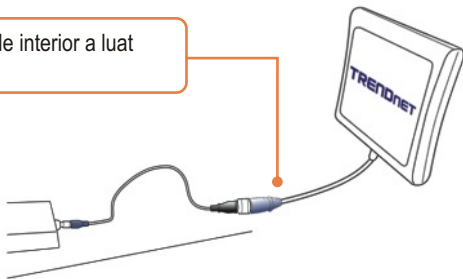

Limited Warranty

TRENDnet warrants its products against defects in material and workmanship, under normal use and service, for the following lengths of time from the date of purchase.

TEW-ASAK, TEW-L202, TEW-L208, TEW-L406, TEW-L412 - 3 Year Warranty
TEW-AO08O, TEW-AO10O, TEW-AO09D, TEW-AO14D, TEW-AO19D- 3 Year Warranty

If a product does not operate as warranted above during the applicable warranty period, TRENDnet shall, at its option and expense, repair the defective product or part, deliver to customer an equivalent product or part to replace the defective item, or refund to customer the purchase price paid for the defective product. All products that are replaced will become the property of TRENDnet. Replacement products may be new or reconditioned.

TRENDnet shall not be responsible for any software, firmware, information, or memory data of customer contained in, stored on, or integrated with any products returned to TRENDnet pursuant to any warranty.

There are no user serviceable parts inside the product. Do not remove or attempt to service the product by any unauthorized service center. This warranty is voided if (i) the product has been modified or repaired by any unauthorized service center, (ii) the product was subject to accident, abuse, or improper use (iii) the product was subject to conditions more severe than those specified in the manual.

Warranty service may be obtained by contacting TRENDnet office within the applicable warranty period for a Return Material Authorization (RMA) number, accompanied by a copy of the dated proof of the purchase. Products returned to TRENDnet must be pre-authorized by TRENDnet with RMA number marked on the outside of the package, and sent prepaid, insured and packaged appropriately for safe shipment.

WARRANTIES EXCLUSIVE: IF THE TRENDnet PRODUCT DOES NOT OPERATE AS WARRANTED ABOVE, THE CUSTOMER'S SOLE REMEDY SHALL BE, AT TRENDnet'S OPTION, REPAIR OR REPLACEMENT. THE FOREGOING WARRANTIES AND REMEDIES ARE EXCLUSIVE AND ARE IN LIEU OF ALL OTHER WARRANTIES, EXPRESSED OR IMPLIED, EITHER IN FACT OR BY OPERATION OF LAW, STATUTORY OR OTHERWISE, INCLUDING WARRANTIES OF MERCHANTABILITY AND FITNESS FOR A PARTICULAR PURPOSE. TRENDnet NEITHER ASSUMES NOR AUTHORIZES ANY OTHER PERSON TO ASSUME FOR IT ANY OTHER LIABILITY IN CONNECTION WITH THE SALE, INSTALLATION MAINTENANCE OR USE OF TRENDnet'S PRODUCTS.

TRENDnet SHALL NOT BE LIABLE UNDER THIS WARRANTY IF ITS TESTING AND EXAMINATION DISCLOSE THAT THE ALLEGED DEFECT IN THE PRODUCT DOES NOT EXIST OR WAS CAUSED BY CUSTOMER'S OR ANY THIRD PERSON'S MISUSE, NEGLIGENCE, IMPROPER INSTALLATION OR TESTING, UNAUTHORIZED ATTEMPTS TO REPAIR OR MODIFY, OR ANY OTHER CAUSE BEYOND THE RANGE OF THE INTENDED USE, OR BY ACCIDENT, FIRE, LIGHTNING, OR OTHER HAZARD.

LIMITATION OF LIABILITY: TO THE FULL EXTENT ALLOWED BY LAW TRENDnet ALSO EXCLUDES FOR ITSELF AND ITS SUPPLIERS ANY LIABILITY, WHETHER BASED IN CONTRACT OR TORT (INCLUDING NEGLIGENCE), FOR INCIDENTAL, CONSEQUENTIAL, INDIRECT, SPECIAL, OR PUNITIVE DAMAGES OF ANY KIND, OR FOR LOSS OF REVENUE OR PROFITS, LOSS OF BUSINESS, LOSS OF INFORMATION OR DATE, OR OTHER FINANCIAL LOSS ARISING OUT OF OR IN CONNECTION WITH THE SALE, INSTALLATION, MAINTENANCE, USE, PERFORMANCE, FAILURE, OR INTERRUPTION OF THE POSSIBILITY OF SUCH DAMAGES, AND LIMITS ITS LIABILITY TO REPAIR, REPLACEMENT, OR REFUND OF THE PURCHASE PRICE PAID, AT TRENDnet'S OPTION. THIS DISCLAIMER OF LIABILITY FOR DAMAGES WILL NOT BE AFFECTED IF ANY REMEDY PROVIDED HEREIN SHALL FAIL OF ITS ESSENTIAL PURPOSE.

Governing Law: This Limited Warranty shall be governed by the laws of the state of California.

AC/DC Power Adapter, Cooling Fan, and Power Supply carry 1 Year Warranty



TRENDnet Technical Support

US • Canada

Toll Free Telephone: 1(866) 845-3673

24/7 Tech Support

Europe (Germany • France • Italy • Spain • Switzerland • UK)

Toll Free Telephone: +00800 60 76 76 67

English/Espanol - 24/7

Francais/Deutsch - 11am-8pm, Monday - Friday MET

Worldwide

Telephone: +[31] (0) 20 504 05 35

English/Espanol - 24/7

Francais/Deutsch - 11am-8pm, Monday - Friday MET



Product Warranty Registration

Please take a moment to register your product online.

Go to TRENDnet's website at <http://www.trendnet.com>

TRENDnet[®]
20675 Manhattan Place
Torrance, CA 90501
USA